

Adaptador Férula clamp x Rosca NPT *Pipe Thread; Non 3A*

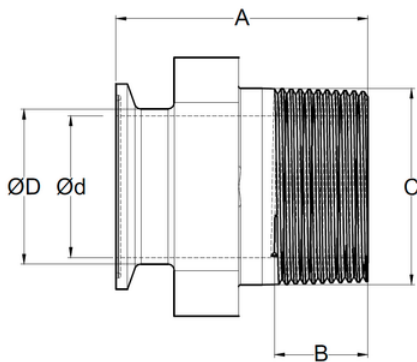

SIZE	ØD	Ød	A	B	C	# Parte / Ac. Inox 304	# Parte / Ac. Inox 316L
1/2"x1/2"	0.500" 12.7 mm	0.370" 9.398 mm	2.000" 50.8 mm	0.7815" 19.85 mm	0.840" 21.336 mm	D01304 0505	D01316L 0505
1/2"x3/4"	0.500" 12.7 mm	0.370" 9.398 mm	2.000" 50.8 mm	0.7935" 20.154 mm	1.050" 26.67 mm	D01304 0507	D01316L 0507
3/4"x1/2"	0.750" 19.05 mm	0.620" 15.758 mm	2.000" 50.8 mm	0.7815" 19.85 mm	0.840" 21.336 mm	D01304 0705	D01316L 0705
3/4"x3/4"	0.750" 19.05 mm	0.620" 15.758 mm	2.000" 50.8 mm	0.7935" 20.154 mm	1.050" 26.67 mm	D01304 0707	D01316L 0707
3/4"x1"	0.750" 19.05 mm	0.620" 15.758 mm	2.000" 50.8 mm	0.9845" 25 mm	1.315" 33.401 mm	D01304 0710	D01316L 0710
1"x1/2"	1.000" 25.4 mm	0.870" 22.098 mm	2.190" 55.626 mm	0.7815" 19.85 mm	0.840" 21.336 mm	D01304 1005	D01316L 1005
1"x3/4"	1.000" 25.4 mm	0.870" 22.098 mm	2.190" 55.626 mm	0.7935" 20.154 mm	1.050" 26.67 mm	D01304 1007	D01316L 1007
1"x1"	1.000" 25.4 mm	0.870" 22.098 mm	2.250" 57.15 mm	0.9845" 25 mm	1.315" 33.401 mm	D01304 1010	D01316L 1010
1"x1-1/2"	1.000" 25.4 mm	0.870" 22.098 mm	2.000" 50.8 mm	1.0252" 26.04 mm	1.900" 48.26 mm	D01304 1015	D01316L 1015
1-1/2"x1/2"	1.500" 38.1 mm	1.370" 34.798 mm	2.190" 55.626 mm	0.7815" 19.85 mm	0.840" 21.336 mm	D01304 1505	D01316L 1505
1-1/2"x3/4"	1.500" 38.1 mm	1.370" 34.798 mm	2.190" 55.626 mm	0.7935" 20.154 mm	1.050" 26.67 mm	D01304 1507	D01316L 1507
1-1/2"x1"	1.500" 38.1 mm	1.370" 34.798 mm	2.250" 57.15 mm	0.9845" 25 mm	1.315" 33.401 mm	D01304 1510	D01316L 1510
1-1/2"x1-1/2"	1.500" 38.1 mm	1.370" 34.798 mm	2.440" 61.976 mm	1.0252" 26.04 mm	1.900" 48.26 mm	D01304 1515	D01316L 1515
1-1/2"x2"	1.500" 38.1 mm	1.370" 34.798 mm	2.620" 66.548 mm	1.0582" 26.878 mm	2.375" 60.325 mm	D01304 1520	D01316L 1520
2" x 1/2"	2.000" 50.8 mm	1.870" 47.498 mm	2.190" 55.626 mm	0.7815" 19.85 mm	0.840" 21.336 mm	D01304 2005	D01316L 2005
2" x 3/4"	2.000" 50.8 mm	1.870" 47.498 mm	2.190" 55.626 mm	0.7935" 20.154 mm	1.050" 26.67 mm	D01304 2007	D01316L 2007
2" x 1"	2.000" 50.8 mm	1.870" 47.498 mm	2.250" 57.15 mm	0.9845" 25 mm	1.315" 33.401 mm	D01304 2010	D01316L 2010
2" x 1-1/2"	2.000" 50.8 mm	1.870" 47.498 mm	2.470" 62.738 mm	1.0252" 26.04 mm	1.900" 48.26 mm	D01304 2015	D01316L 2015
2" x 2"	2.000" 50.8 mm	1.870" 47.498 mm	2.660" 67.564 mm	1.0582" 26.878 mm	2.375" 60.325 mm	D01304 2020	D01316L 2020
2-1/2"x1-1/2"	2.500" 63.5 mm	2.370" 60.198 mm	2.780" 70.612 mm	1.0252" 26.04 mm	1.900" 48.26 mm	D01304 2515	D01316L 2515
2-1/2"x2"	2.500" 63.5 mm	2.370" 60.198 mm	2.780" 70.612 mm	1.0582" 26.878 mm	2.375" 60.325 mm	D01304 2520	D01316L 2520
2-1/2"x2-1/2"	2.500" 63.5 mm	2.370" 60.198 mm	3.280" 83.312 mm	1.5712" 39.908 mm	2.875" 73.025 mm	D01304 2525	D01316L 2525
3" x 2"	3.000" 76.2 mm	2.870" 72.898 mm	3.500" 88.9 mm	1.0582" 26.878 mm	2.375" 60.325 mm	D01304 3020	D01316L 3020
3" x 2-1/2"	3.000" 76.2 mm	2.870" 72.898 mm	3.500" 88.9 mm	1.5712" 39.908 mm	2.875" 73.025 mm	D01304 3025	D01316L 3025
3" x 3"	3.000" 76.2 mm	2.870" 72.898 mm	3.500" 88.9 mm	1.6337" 39.908 mm	3.500" 88.9 mm	D01304 3030	D01316L 3030
4" x 3"	4.000" 101.6 mm	3.834" 97.383 mm	3.810" 96.774 mm	1.6337" 39.908 mm	3.500" 88.9 mm	D01304 4030	D01316L 4030
4" x 4"	4.000" 101.6 mm	3.834" 97.383 mm	3.810" 96.774 mm	1.7337" 44.035 mm	4.500" 114.3 mm	D01304 4040	D01316L 4040